

COMMERCIAL FANS

OFFICES, RETAIL, LEISURE AND EDUCATION





LESS IS MORE



Energy efficient, high performance
and ultra hygienic

Commercial Fans

Why Ventilate?

AIRFLOW'S extensive range of extract fans are not just for domestic dwellings. Their outstanding performance, ease of installation and aesthetic appeal ensures that they can efficiently complement virtually any installation and help comply with the Building Regulations for non-domestic installations.

Refer to the CIBSE guidelines for recommended air changes per hour in non-domestic installations

Aventa Silent

n-Line fans can be used in the ceiling void to ventilate areas that require a ducted application.

The perfect choice for ventilation where a ducted solution is required. As the fan is mounted in the ceiling void, noise levels are kept to a minimum in the room.

Aventa Turbo

In-Line fans which use centrifugal fan technology offering increased pressure performance for larger spaces and commercial applications. The noise level is not an issue as the fan is located in the ceiling void above the area being ventilated.

Visit [Airflow.com](https://www.airflow.com) to learn more about our residential product range.



For the latest ventilation news, information, product data and application advice

[CLICK](#) [CALL](#) [VISIT](#)

[airflow.com](https://www.airflow.com)



Aventa In-Line

Bathroom, en-suite, utility room and kitchen ventilation



KEY FEATURES

- In-Line mixed flow fan with flow rate up to 78 l/s (280 m³/h)
- High pressure, low noise
- Two speed (normal and boost)
- Adjustable Run on Timer version available
- Low Watt motor from 21 W
- IPX4 rating
- 3 year warranty

The Aventa range provides compact, quiet and powerful remote mounted ventilation for ducted installations. Available in high performance, two speed versions they are less bulky than larger in-line centrifugal fans and can be installed in loft spaces or service shafts for remote extraction.

With high flow / high pressure development characteristics they can be used with flexible ducting and flat duct systems to ensure compliance with Building Regulations guidance ensuring installed performance and extraction conditions are met.

Combining two Aventa fans allows for even more powerful operation. Mounting in parallel (left hand image on facing page) doubles the air flow, whilst two fans in series (right hand image on facing page) leads to a doubling of the air pressure for longer duct runs.

MODELS

Basic	Control by Remote Switch
Timer	Adjustable timer overrun between 2 and 30 minutes

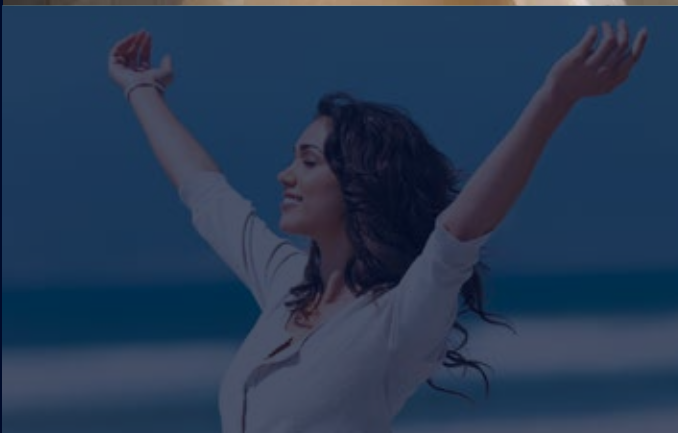

TECHNICAL DATA

Specification	Aventa 100B	Aventa 100T	Aventa 125B	Aventa 125T
Air flow m ³ /h	145 / 187		220 / 280	
Air flow l/s	40 / 52		61 / 78	
Fan type	Mixed Flow			
Controls	Basic	Timer	Basic	Timer
Mounting	In-Line			
Sound pressure dB(A)@3 m	27 / 36		28 / 37	
Power Watts	21 / 33		23 / 37	
Amps	0.11 / 0.21		0.18 / 0.27	
Building Regulations ADF	Yes			
Duct diameter (mm)	100		125	
Voltage	230 V / 1 ph / 50 Hz			
Rating	IPX4			
Material finish	ABS			
Weight (kg)	1.5			
Dimensions (H x W x D) mm	190 x 246 x 126		190 x 246 x 136	
Part No.	9041085	9041086	9041087	9041088
EAN	5019009305448	5019009305455	5019009305462	5019009305479

DIMENSIONS (mm)

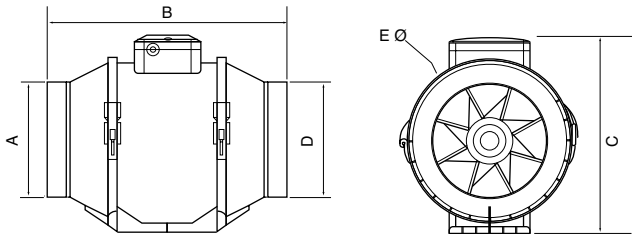

Model	A	B	C	D	E
AV100	96	246	190	96	96
AV125	123	246	190	123	123

Double the flow - mount in parallel

Double the pressure - mount in series



PERFORMANCE

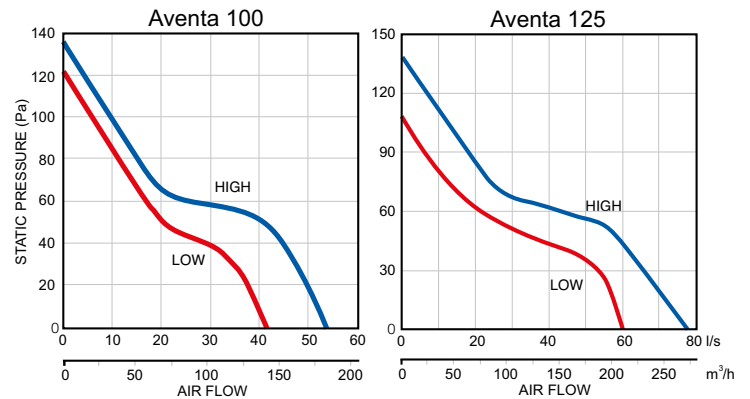

CONTROLS & ACCESSORIES



Led Bulb
Cool White
No: 90001384
Replacement LED bulb for Aventa shower kits with light; (4W 12V AC/DC 6000K).



AV100T Shower Kit + L
(Pack of 4)
No: 9041408OP
Aventa In-Line 100mm Fan kit with light (Pack of 4).



AV100T Shower Kit T
(Pack of 4)
No: 9041407OP
Aventa In-Line 100mm Fan kit/ Adjustable timer (Pack of 4).



Aventa AV125T
(Pack of 4)
No: 9041406OP
Aventa In-Line 125mm Fan kit/ Adjustable timer (Pack of 4).

Others products available from airflow.com

Aventa Silent

Domestic and light commercial facilities



KEY FEATURES

- | In-line mixed flow fan, with flow rates up to 569 l/s (2050 m³/h)
- | Suitable for toilets, en-suites, bathrooms, utility rooms, kitchens and light commercial applications
- | Two speed (normal and boost)
- | Timer (T) versions available
- | Features sound insulated casing to ensure low noise levels
- | IPX4 rating
- | 2 year warranty



The durable external casing is made of polymer coated steel. The inner casing perforation lets sound waves pass through the holes and fall at a specific angle to the sound absorbing layer. The casing is internally heat and sound insulated with a 50 mm mineral layer and the conic impeller with special blade profiling increases air flow speed and provides higher pressure.

The diffuser, specially profiled impeller and directing vanes at the outlet from the fan casing distribute air flow in such a way as to attain the best combination of performance and pressure at low noise levels.

The fans can be mounted at any place or angle within the ductwork. Several fans can be installed in parallel in the same system to achieve a higher air capacity or in series to achieve higher pressure.

Recommended as a component of an air handling systems for commercial and industrial premises where noise levels need to be kept to a minimum, for example, libraries, conference rooms, educational institutions and crèches.

MODELS

Basic	Control by optional switch (switch not included)
Timer	Adjustable timer overrun between 2 and 30 minutes.



TECHNICAL DATA

Specification	Aventa Silent AVS100		Aventa Silent AVS125		Aventa Silent AVS150		Aventa Silent AVS200		Aventa Silent AVS250		Aventa Silent AVS315	
Air flow m ³ /h	170 / 240		230 / 340		405 / 555		810 / 1020		1110 / 1400		1570 / 2050	
Air flow l/s	47 / 67		64 / 94		112 / 154		225 / 283		308 / 389		436 / 569	
Fan type	Mixed Flow											
Controls	Basic	Timer	Basic	Timer	Basic	Timer	Basic	Timer	Basic	Timer	Basic	Timer
Mounting	In-Line											
Sound Pressure dB(A)@3m	24 / 29		23 / 28		26 / 33		31 / 36		34 / 38		36 / 40	
Power Watts	24 / 26		25 / 30		45 / 52		78 / 110		125 / 177		230 / 330	
Amps	0.10 / 0.11		0.11 / 0.13		0.20 / 0.23		0.35 / 0.49		0.54 / 0.79		1.0 / 1.42	
Building Regulations ADF	Yes											
Duct diameter (mm)	100		125		150		200		250		315	
Voltage	230 V / 1 ph / 50 Hz											
Rating	IPX4											
Material finish	Polymer Coated Steel											
Weight (kg)	4.6		4.6		6.1		8		15		25	
Dimensions (H x W x D) mm	237 x 505 x 243		237 x 474 x 243		260 x 580 x 274		295 x 550 x 386		360 x 658 x 445		434 x 780 x 520	
Part No.	90000358	90002118	90000359	90002119	90000360	90002120	90000361	90002121	90002105	90002122	90002106	90002123
EAN	5019009313290	5019009335858	5019009313306	5019009335865	5019009313313	5019009335872	5019009313320	5019009335889	5019009335735	5019009335896	5019009335742	5019009335902
Speed controller No.	9041565		9041565		9041565		9041565		9041565		9041565	

PERFORMANCE (mm)

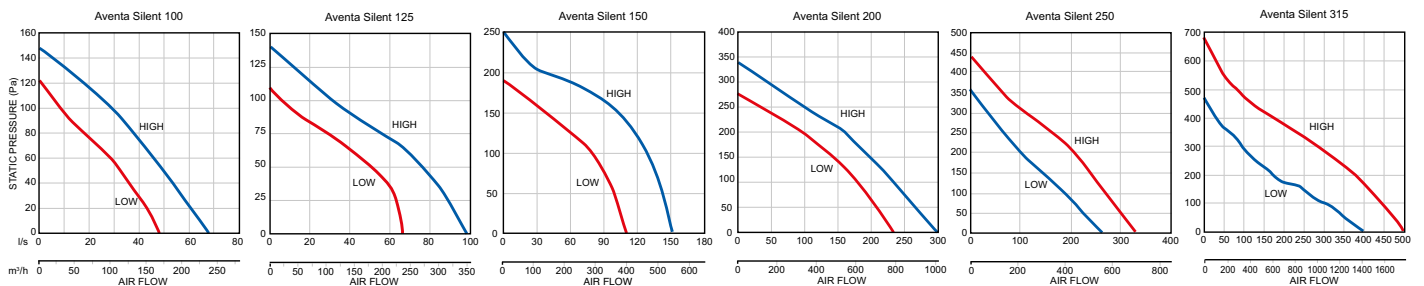



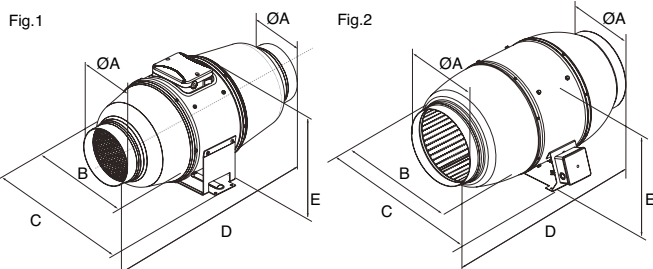

DIMENSIONS



Model	AØ	B	C	D	E	Figure No.
AVS 100	98	215	243	505	237	1
AVS 125	123	215	243	474	237	1
AVS 150	147	247	274	580	260	1
AVS 200	198	293	389	550	295	2
AVS 250	248	358	445	658	360	2
AVS 315	313	432	520	780	434	2

CONTROLS & ACCESSORIES

 <p>Isolation Switch No: 90000538 Single gang two pole latching modular isolation switch (on/off) with a red neon indicator in a smooth, polar white finish.</p>	 <p>ON/OFF Switch No: 90000540 Single gang, single pole latching on/off switch in a smooth, polar white finish.</p>
 <p>Humidistat No: 9041570 Wall mounted electrical humidistat for switching the ventilator on or off according to the degree of humidity in the air. IP30 rated.</p>	 <p>ON/OFF Switch with Lock Isolator No: 90000547 Single gang single pole latching modular on/off switch with lock isolator module in a smooth, polar white finish.</p>

Others products available from airflow.com

Aventa Turbo

Domestic and light commercial facilities



KEY FEATURES



- | In-Line centrifugal fan, with Flow rates up to 372 l/s (1340 m³/h)
- | Designed for ventilation of medium and large size facilities
- | Suitable for variable speed control
- | Supply or extract air
- | External rotor motor with ball-bearings with thermal protection
- | IPX4 rating
- | 3 year warranty

Highly reliable and powerful fan in a modular design for ease of installation and maintenance. The Aventa Turbo series are designed to provide ventilation levels that comply with the latest Building Regulations. Works particularly well against higher system pressure.

Operated by basic switching (switch not supplied), these fans can be installed in loft spaces or service shafts for remote extraction with minimal room noise.

The extensive range of Aventa Turbo fans provide compact, quiet and powerful remote mounted ventilation for ducted installations. Fans can be mounted vertically, horizontally or at an inclined angle for versatility of installation.

MODELS

Basic

Control by basic switching (switch not included)



TECHNICAL DATA

Specification	Aventa Turbo 100B	Aventa Turbo 125B	Aventa Turbo 150B	Aventa Turbo 200B	Aventa Turbo 250B	Aventa Turbo 315B
Air flow m ³ /h / l/s	250 / 69	355 / 98	460 / 127	780 / 216	1080 / 300	1340 / 372
Fan type	Centrifugal					
Controls	Basic					
Mounting	In-Line					
Sound pressure dB(A)@3 m	46	46	46	48	50	50
Power Watts	80	79	89	107	173	200
Amps	0.34	0.34	0.35	0.47	0.76	0.88
Building Regulations ADF	YES					
Duct diameter (mm)	100	125	150	200	250	315
Voltage	230 V / 1 ph / 50 Hz					
Rating	IPX4					
Material finish	Plastic					
Weight (kg)	2.15	2.2	2.4	3.0	4.3	4.8
Dimensions (H x W x D) mm	250 x 270 x 230	250 x 270 x 230	300 x 310 x 286	340 x 354 x 276	340 x 354 x 265	400 x 414 x 276
Part No.	9041360	9041361	9041362	9041363	9041364	9041365
Speed controller No.	9041565					
EAN	5019009306728	5019009307008	5019009307015	5019009307022	5019009307039	5019009307046

DIMENSIONS (mm)

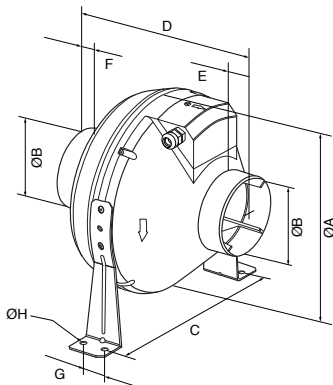

Model	A	B	C	D	E	F	G	H	Dimensions
AVT 100B	250	100	270	230	30	27	30	6	250 x 270 x 230
AVT 125B	250	125	270	220	30	27	30	6	250 x 270 x 230
AVT 150B	300	150	310	286	30	30	30	6	300 x 310 x 286
AVT 200B	340	200	354	276	30	30	40	6	340 x 354 x 276
AVT 250B	340	250	354	265	30	30	40	6	340 x 354 x 265
AVT 315B	400	315	414	276	40	55	30	6	400 x 414 x 276

PERFORMANCE

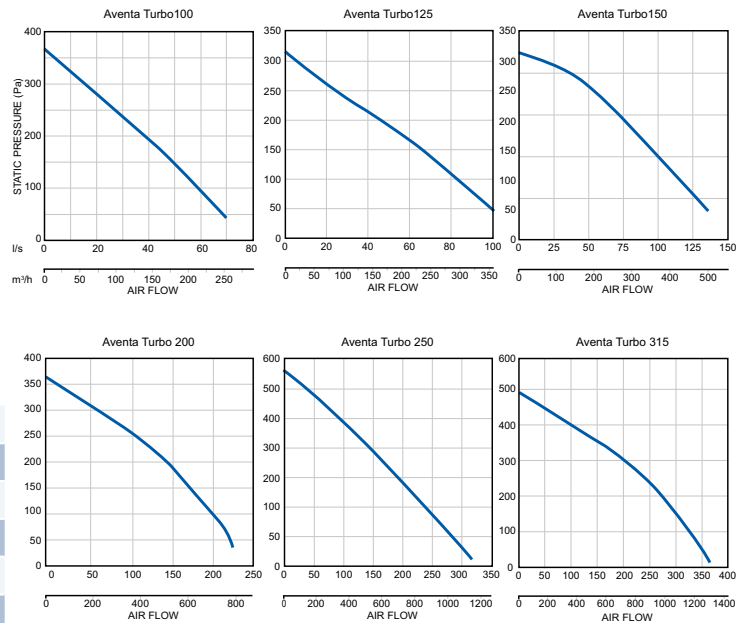

CONTROLS & ACCESSORIES

Isolation Switch
No: 90000538

Single gang two pole latching modular isolation switch (on/off) with a red neon indicator in a smooth, polar white finish.

Humidistat
No: 9041570

Wall mounted electrical humidistat for switching the ventilator on or off according to the degree of humidity in the air. IP30 rated.

ON/OFF Switch
No: 90000540

Single gang, single pole modular latching on/off switch in a smooth, polar white finish.

ON/OFF Switch with Lock Isolator
No: 90000547

Single gang single pole latching modular on/off switch with lock isolator module in a smooth, polar white finish.



UNITED KINGDOM (head office)

Airflow Developments Limited
Aidelle House, Lancaster Road
Cressex Business Park
High Wycombe, Bucks. HP12 3QP.

Tel: +44 (0) 1494 525252
Email: info@airflow.com
Web: airflow.com

GERMANY

Airflow Lufttechnik GmbH
Postfach 1208
D-53349
Rheinbach, Germany

Tel: +49 (0) 2226 92050
Email: info@airflow.de
Web: airflow.de

CZECH REPUBLIC

Airflow Lufttechnik - Praha
Hostynska 520
10800 Praha 10
Prague, Czech Republic

Tel: +42 (0) 2747 72230
Email: info@airflow.cz
Web: airflow.cz